

Assembly instructions

Cocoon

Cocoon is shipped unassembled.
This is done for reasons of space and
for reasons of transport safety.

Here we show you how to assemble the parts
yourself with a few simple steps.
assemble the parts yourself.

The box contains
the bed attachment with the rest cushion,
the stainless steel stand and
tools for assembly.

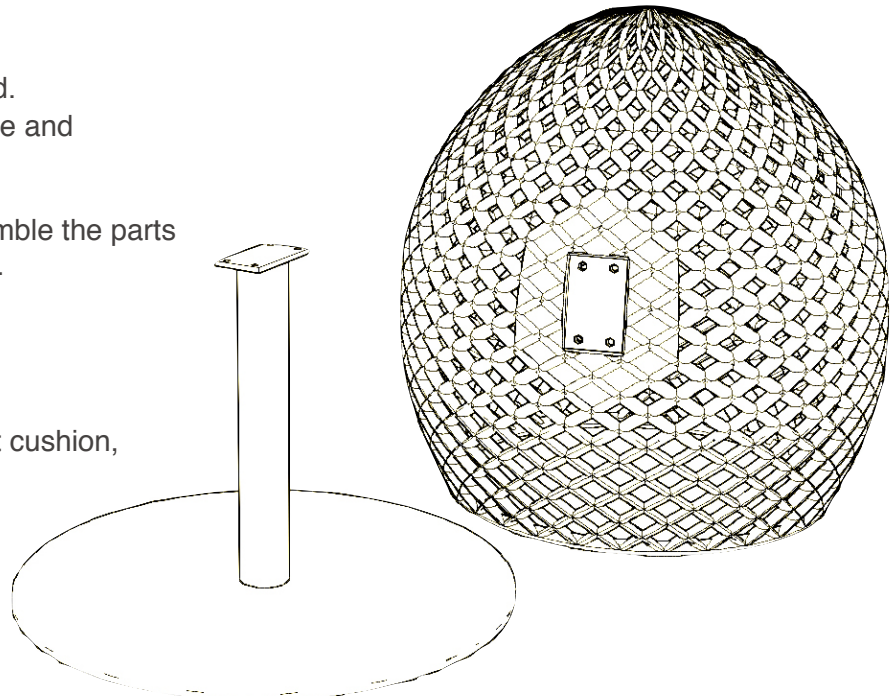

Unscrew the locking nuts from the
the threaded pins on the underside of the bed
and place the attachment on the mounting plate
of the stand so that the grub screws fit into the
holes in the mounting plate
mounting plate.

Translated with DeepL.com (free version)



Now screw the nuts clockwise
clockwise onto the grub screws
and tighten them with a size
tighten them with a size 10 spanner
(metric system) spanner.

If the grub screw also turns,
this can be fixed with the aid of an Imbu spanner
3 mm until the nut is firmly tightened.
tightened. This can also be used to adjust
how far the grub screw protrudes from the surface.
protrudes from the surface.

A spanner and an imbu-
spanner is supplied.

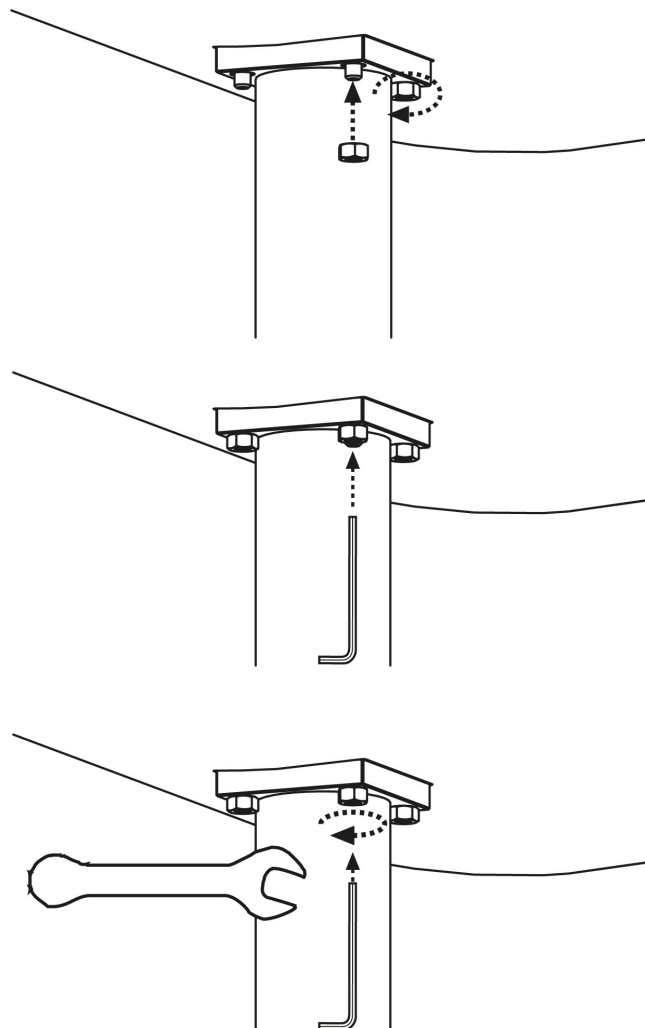

Place the resting cushion in the attachment.

We wish you and your cat
much pleasure with your COCOON cat bed.

